

Congratulations on your purchase of Topeak's ALIEN III tool. It's the first two-piece mini tool designed for both road and mountain cyclists. The ALIEN III tool folds neatly for easy storage and carrying. Each tool is designed for maximum durability and strength for years of trouble-free use.

This guide will instruct you in the proper use of your ALIEN III tool.

Please read all instructions and warnings carefully before using the ALIEN III tool.

The locking lever is used to lock tools in place during use, and to keep tools from deploying when stored. For additional safety, the locking lever is also used for knife blade storage.

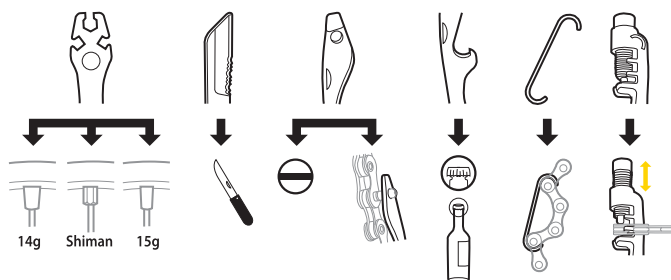
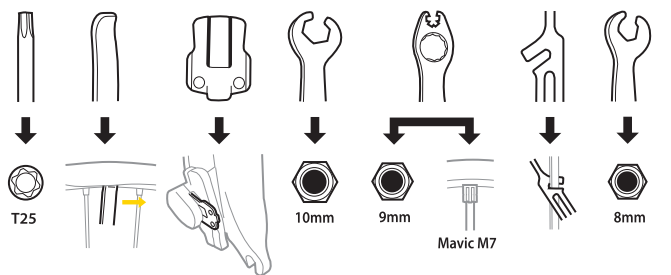
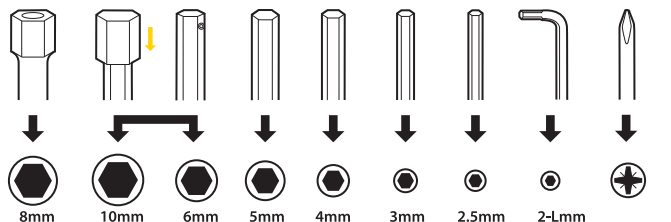
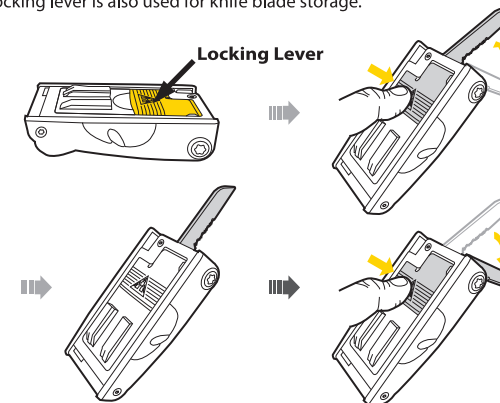

Separating two sections

1. Depress the locking button with your thumb.
2. Slide the sections apart.

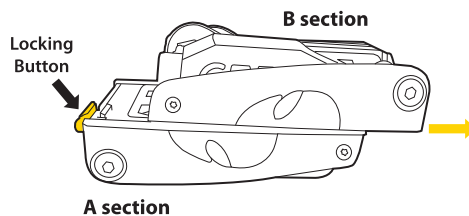

WARNING The knife blade on the ALIEN III is sharp. Be careful when using the knife blade. Use extreme caution when opening and closing your ALIEN III tool.

Using Locking Lever on B section



WARNING The B section contains a very sharp knife blade. Be careful when using the knife blade. Make sure the knife blade is locked securely in the open position when used. Failure to lock knife blade during use can result in serious injury. Be careful when storing knife blade. Make sure all fingers are clear of blade path. Be sure knife blade is locked closed during storage to prevent accidental deployment.

Using the T25 Torx Wrench

Tighten disc brake rotor bolts with the T25 Torx wrench.

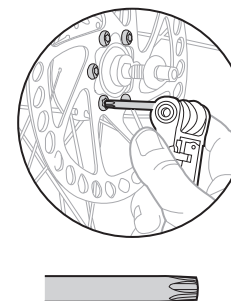

Using the Disc Brake Pad Spacer

Fit a disc brake pad SPACER in each caliper when transporting with unmounted front and/or rear wheel(s) with hydraulic disc brakes.

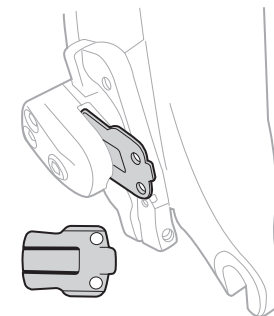

Using the 6mm and 10mm Allen Keys

The 6mm and 10mm Allen keys are combined. Remove the 10mm Allen head to use the 6mm Allen key. Add the 10mm Allen head to use on crank bolts.

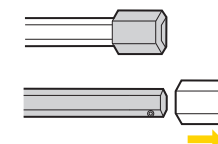

Using Chain Tool

Install new chain pin or remove old chain pin.

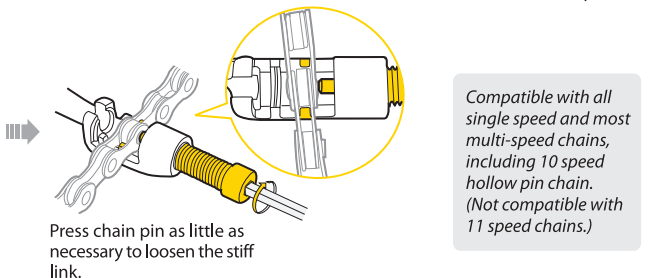
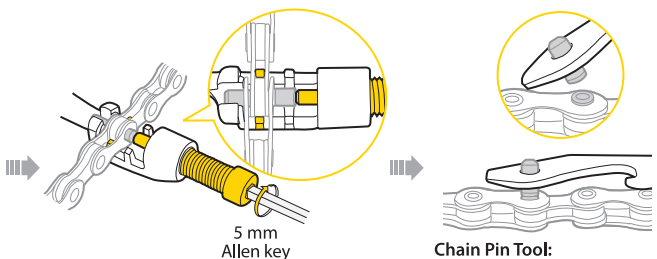
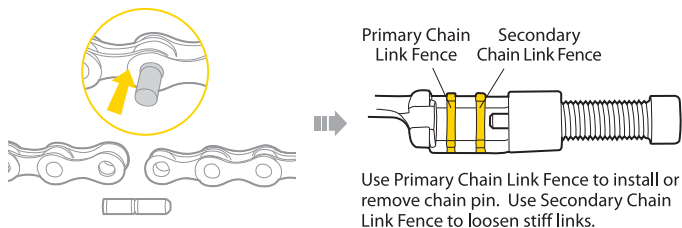

WARNING

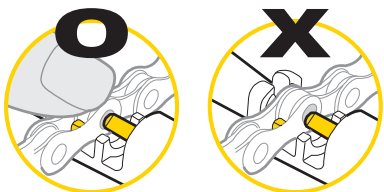

When pressing in the chain pin, push down on the top of the chain to keep it fully engaged in the chain tool cradle. Make sure the press pin of the chain tool is centered against the chain pin.

Spoke Wrenches for Mavic M7

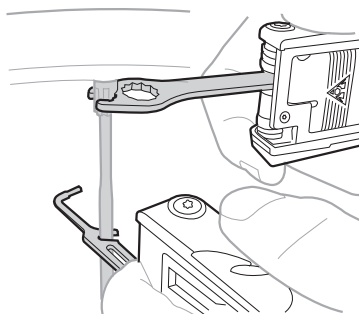

Chain Pin Compartment

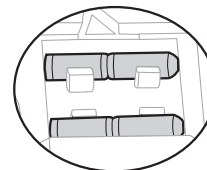
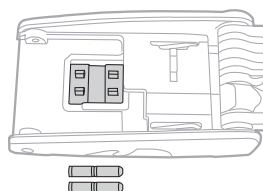

Chain pins are not included.

Tool maintenance

The folding resistance of the A section and the B section can be adjusted by using the 2.5mm Allen key or T25 Torx wrench.

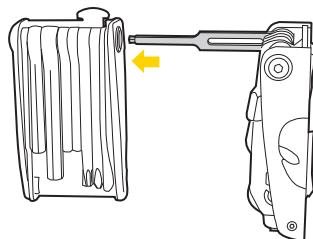

Adjusting folding resistance with 2.5 mm Allen key.

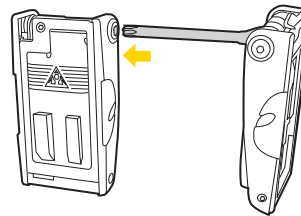

Adjusting folding resistance with T25 Torx wrench.

NOTE:

8mm open end wrench should be used for disc brake bleed nuts only.

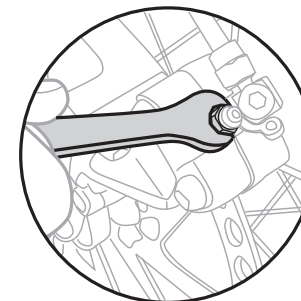

NOTE

1. Lubricate ALiEN III tool with teflon based lubricant when needed. To prevent rusting, keep ALiEN III tool dry.
2. The metal tire lever is designed for durability and for emergency use only. We recommend to use Topeak plastic tire levers, Shuttle Lever 1.1 or 1.2 for regular use and to prevent damage to carbon and alloy rim surfaces.
3. Compatible with all single speed and most multi-speed chains, including 10 speed hollow pin chain. (Not compatible with 11 speed chains.)

WARRANTY

2-year Warranty: All mechanical components against manufacturer defects only.

Warranty Claim Requirements

To obtain warranty service, you must have your original sales receipt. Items returned without a sales receipt will assume that the warranty begins on the date of manufacture. All warranties will be void if The ALiEN III is damaged due to user abuse, tool or body alterations, modification, or used in any way not intended as described in this user's guide.

* The specifications and design are subject to change without notice.

Please contact your Topeak dealer with any questions.
For USA customer service call: 1-800-250-3068
Website: www.topeak.com